

INSTALLATION MANUAL AND INSTRUCTIONS FOR USE

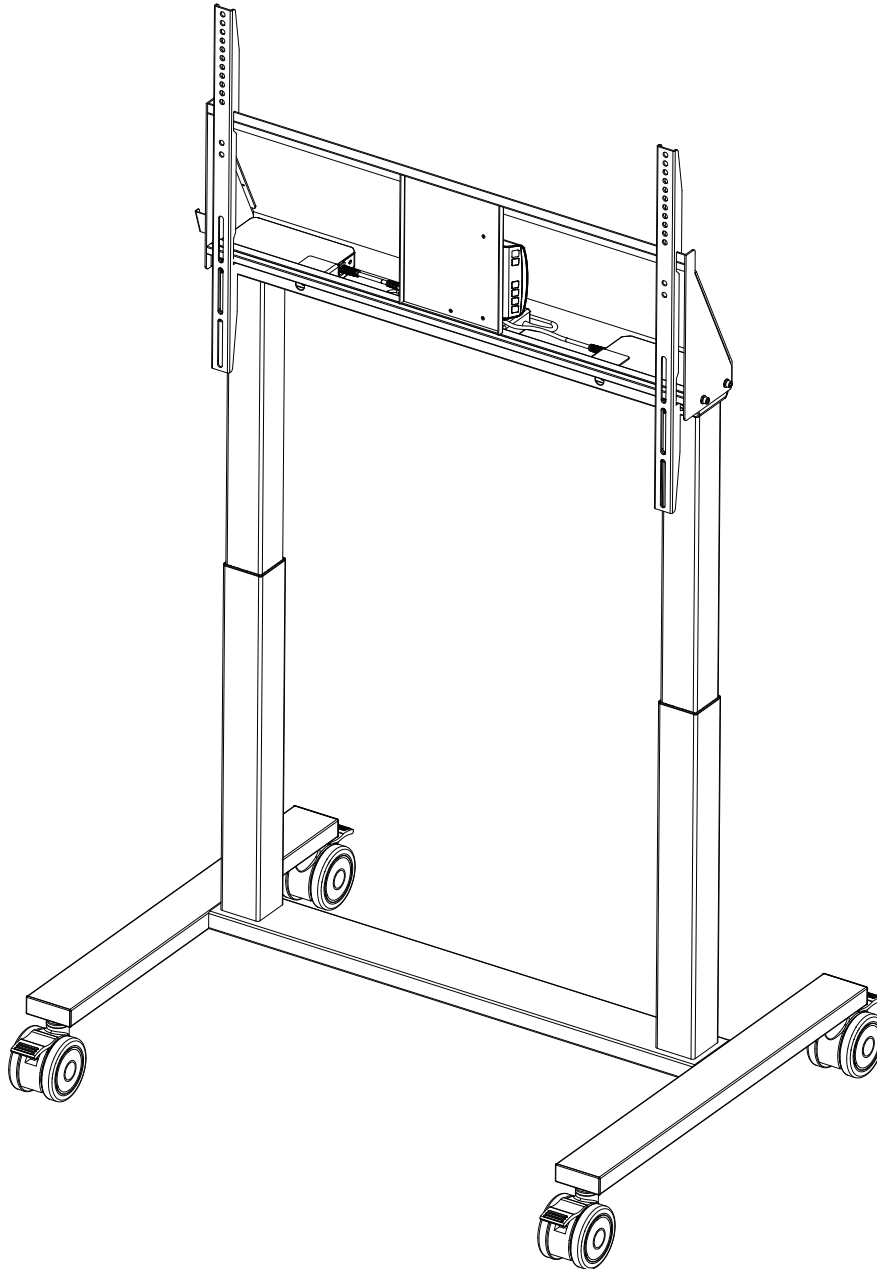

- For using this product properly and safely, please follow the contents of the Installation and Operation Manual to install.
- It is suggested that this Electric Stand applies to the 55–86 inch intelligent panel. Use with other equipment may result in instability causing injury.
- This stand can carry a maximum weight of 100KG.

safety information

Important safety information for both installer and user

Installer:

Before starting the installation read the safety instructions, the mounting regulations and rest of this product manual carefully. Failure to read, thoroughly understand, and follow all instructions can result in serious personal injury, damage to equipment!

User:

Please carefully read the below safety information and user manual (if included) before using the height adjustable mount or trolley. This ensures a failure-free working unit and avoids accidents.

Electrical Safety

Connect unit to a properly grounded outlet only. Make sure, the unit can be immediately separated from the power outlet.

Only use unit in dry rooms, protect it from water and other liquids. Only wipe unit with dry cloth.

Do not open lift unit. RISK OF ELECTRIC SHOCK. There are no serviceable parts inside.

In case of dysfunction unplug unit from power outlet and call an authorised technical service person.

Do not overrun line cord or damage it in any other way. Replace damaged line cords immediately with new identical ones.

Where a plug on the power supply cord is used as the disconnect device, the socket-outlet shall be easily accessible.

Disconnect mains plug before moving the product.

The unit is not dripping or splash water protected. Do not place objects filled with liquids on or spray the unit.

To reduce the risk of electric shock: Always unplug the unit from the electrical outlet before cleaning.

safety information

Mechanical safety

Always keep product's motion path free from obstacles.

Before moving the unit up or down assure at least a safety distance of 20 cm/ 7.9 inch from any part of the unit to any other fitment in order to avoid shear traps or squeezing points.

In case of accident please release operating panel. Movement of unit will stop immediately.

Only operate unit on wheels on plane and stable floors. Move unit on plane floors only.

Risk of tilting when overrunning floor unevennesses, door sills and similar.

Severe risk of injury when unit tips over.

Always move your trolley with the screen in the lowest position.

Do not push the Electric Stand from front or back of lift.

Do not move the Electric Stand by pushing on Display.

The bottom of the monitor or TV's Panel height is not over 0.85m from the ground, after installed.

Hazardous moving parts keep fingers and other body parts away.

Exceeding the weight capacity can result in serious personal injury or damage to equipment! It is the installer's responsibility to make sure the combined weight of all accessories and equipment attached to the product up to (and including) the display

does not exceed the maximum load of 220 lbs / 100 kg. Use with heavier screens may result in instability causing tip over resulting in death or serious injury! The height adjustable feature of this trolley will not function properly if the weight exceeds the given maximum load.

The installation, maintenance and removal of the equipment should be carried by trained professional and skilled personnel.

The intended use of the product:

The product is intended to be used for the mounting and height adjustment of passive or interactive flat screen display panels.

The product is intended for in-door use in classrooms, offices or meeting rooms, at temperatures ranging between 0 to 40 ° C. Please make sure indoor environment is dry and cool. Normal operating humidity is 10%~90%RH. Do not use this product outdoors.

The product is intended for use by adults; children under the age of 16 should only use the product under adult supervision.

Duty cycle: 6 min on/ 30 min off. The Electric Stand motors are intended for intermittent use, continuous or extended use (more than 6 minutes) will cause over heating and a safety system will switch the motors off, if this happens allow the motors to cool down for at least 30 minutes. The system will automatically switch back to normal when the motors have cooled down.

The manufacturer: Room 319, 192 Kezhu Road, Huangpu District, Guangzhou, China

Parts

NOTE:

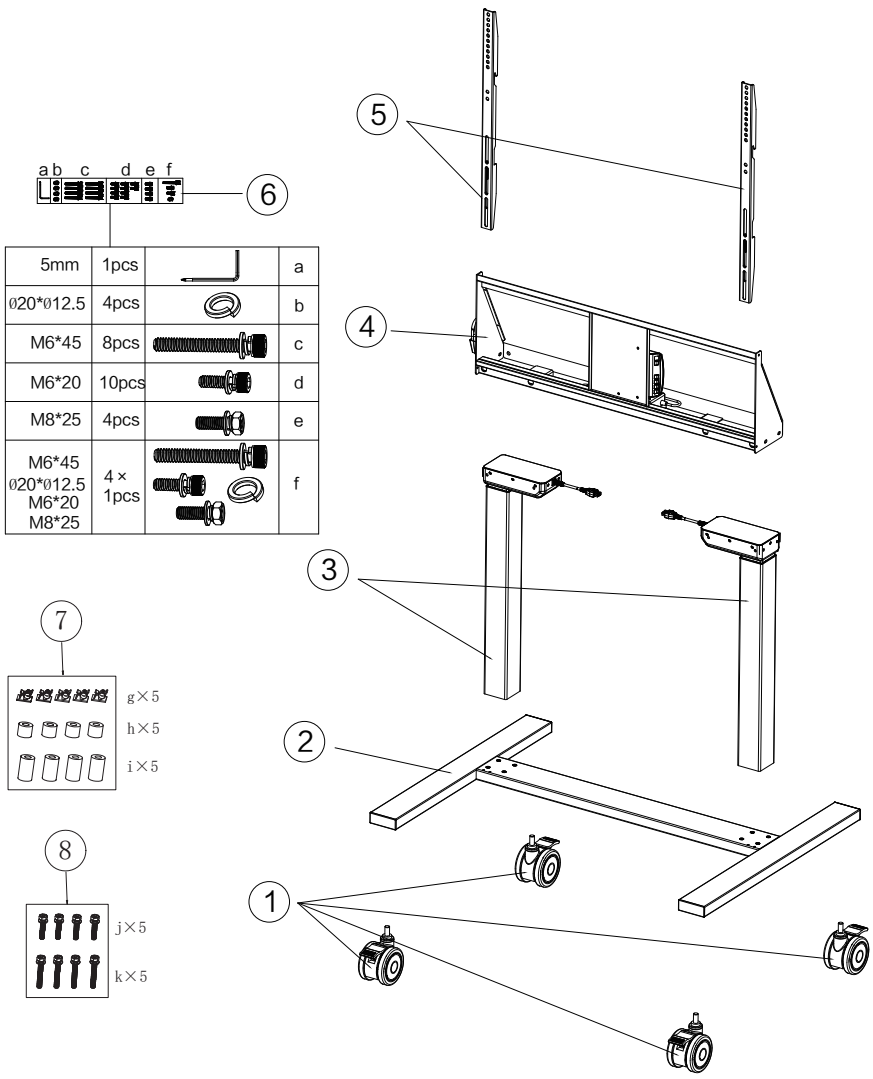
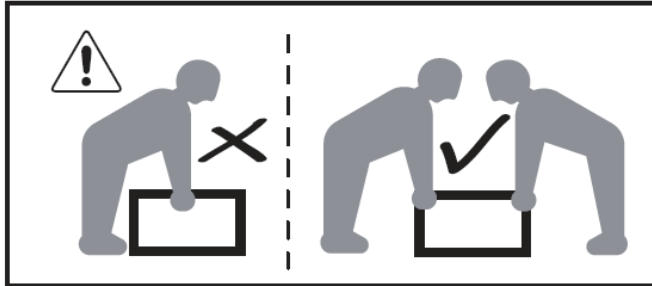



5mm	1pcs		a
∅20*∅12.5	4pcs		b
M6*45	8pcs		c
M6*20	10pcs		d
M8*25	4pcs		e
M6*45 ∅20*∅12.5 M6*20 M8*25	4 × 1pcs		f

	g × 5
	h × 5
	i × 5

	j × 5
	k × 5

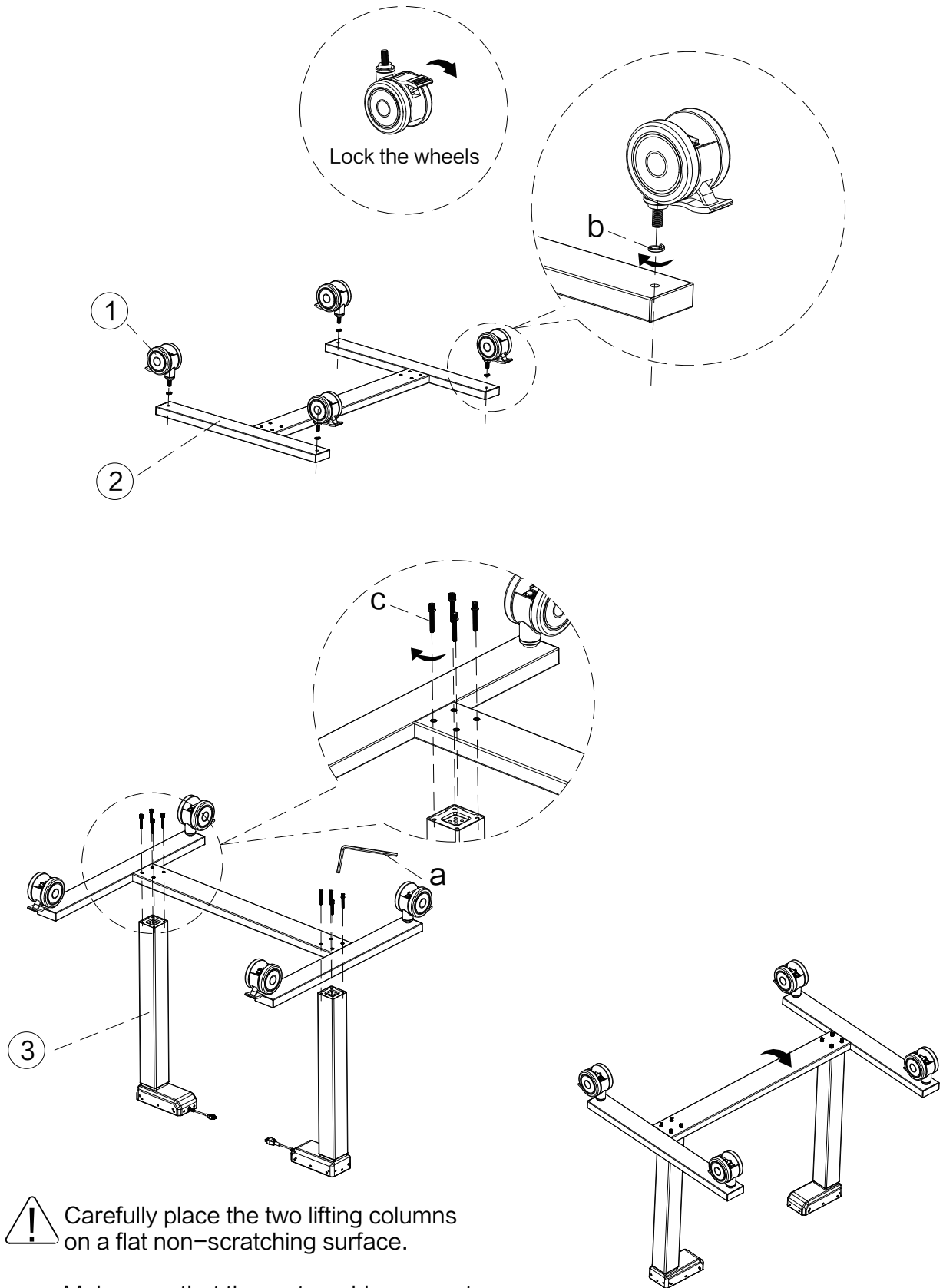
Assembly steps



 Carefully place the two lifting columns on a flat non-scratching surface.

Make sure that the motorcable connectors facing inward .

 After the screws are locked, turn the footstand upside down, with at least two people working.

Assembly steps

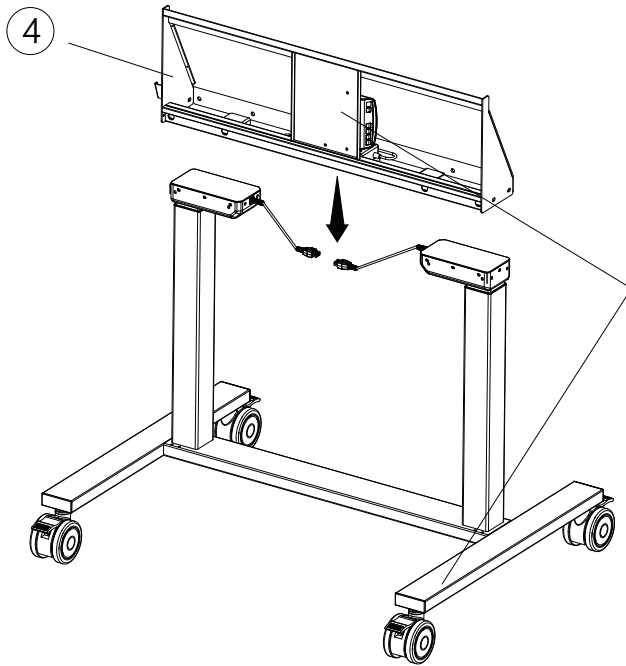

The wall mount assembly faces the longer side of the base leg.

Step 1



The screw only partially locks in, not tightly now.

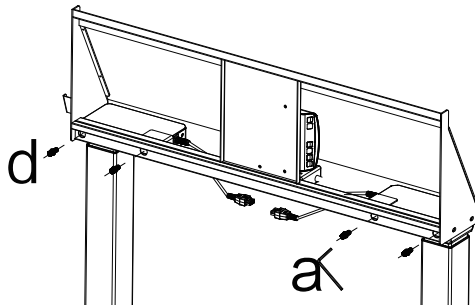

Step 2



The screw only partially locks in, not tightly now.

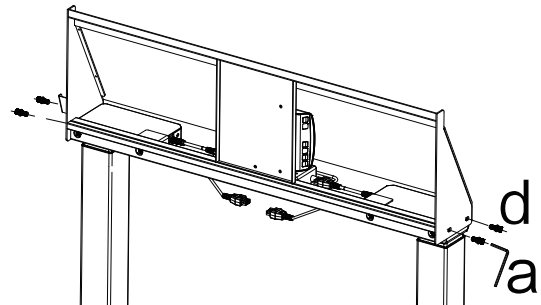

Step 3



Tighten the screws on the frontside.

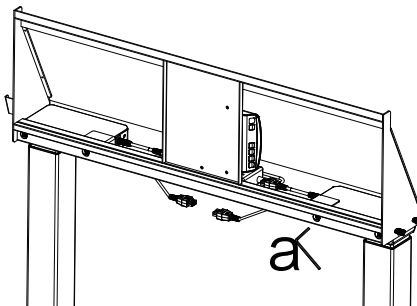

Step 4



Tighten the screws on the both side.

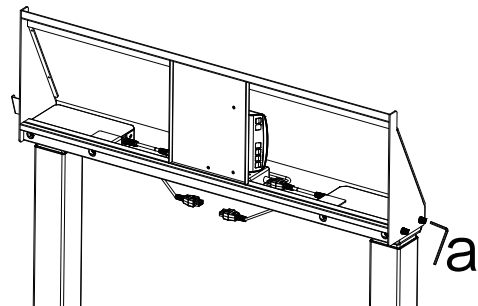

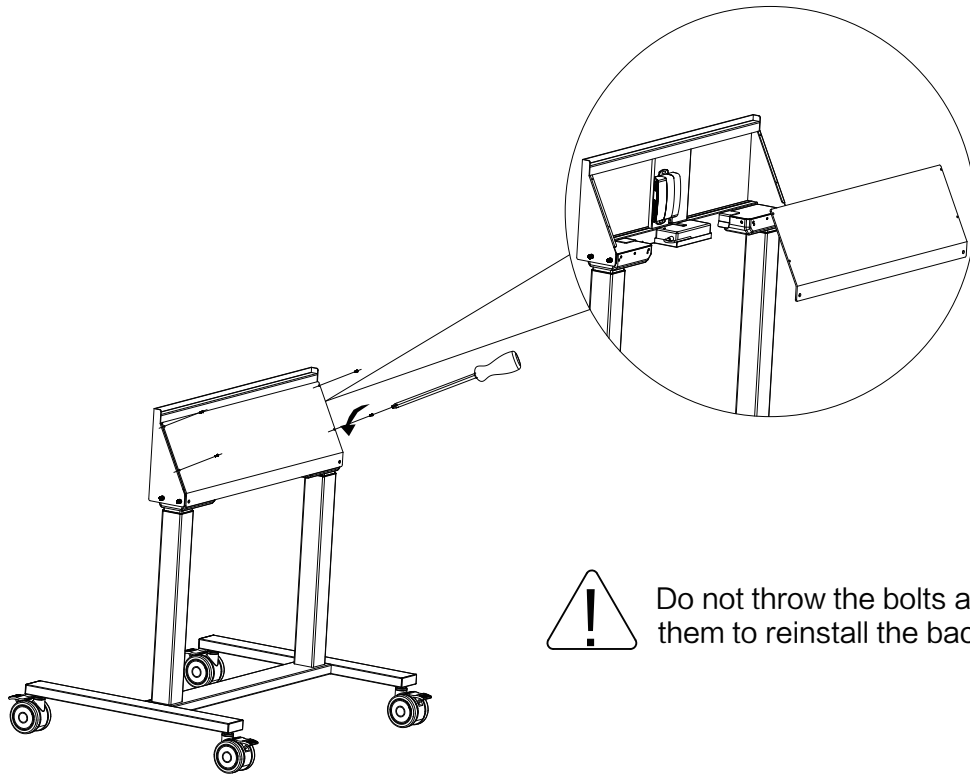

Do not throw the bolts away, save them to reinstall the backcover later.

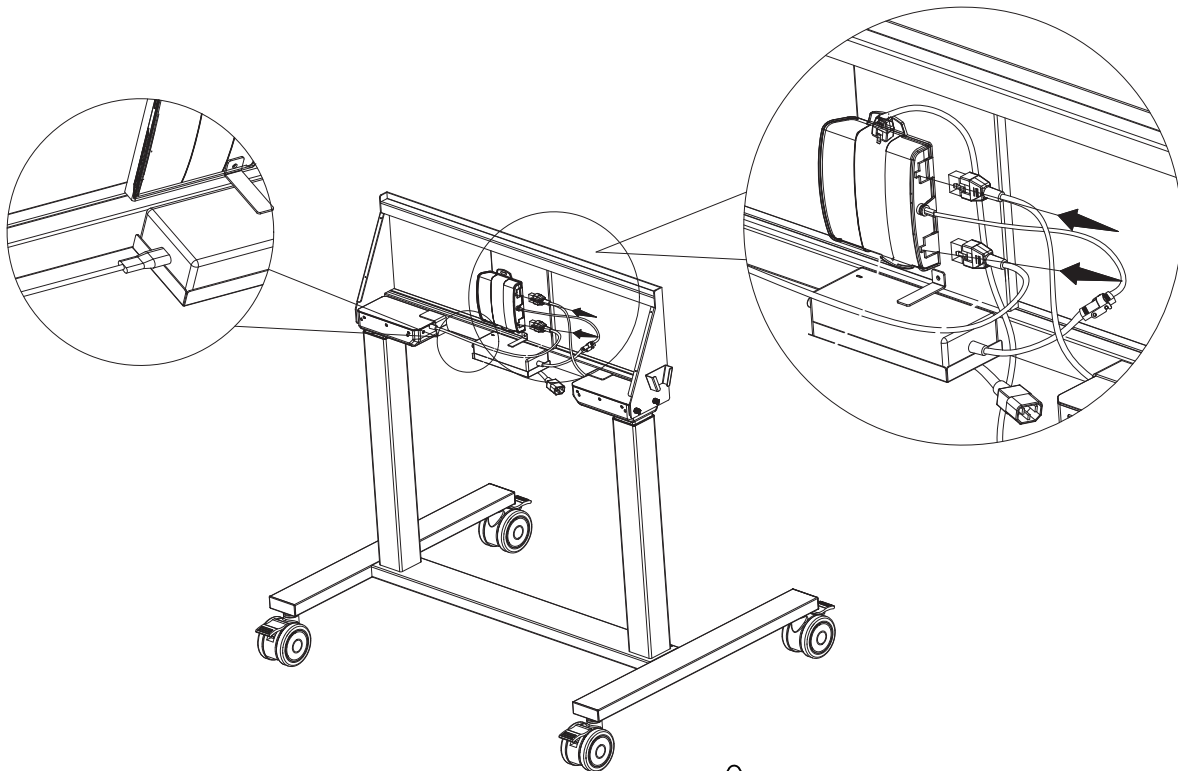

Check that the cable are fitting in the cable slot.

Assembly steps

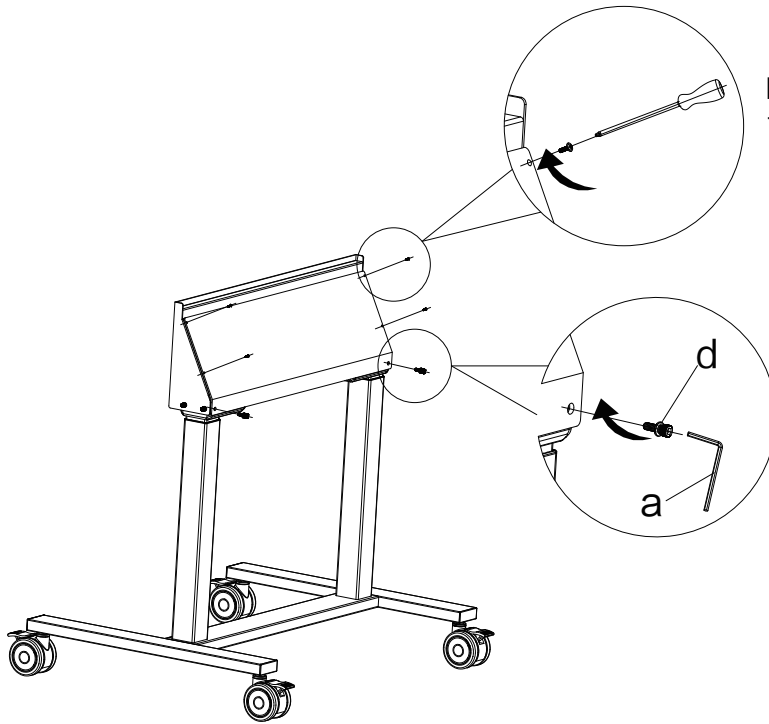

Reinstall the backcover with the four saved bolts.

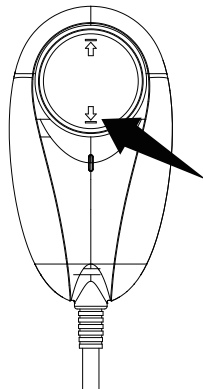

Long press the down button for about 5 seconds, The Electric Stand slowly downward, spring back to the initial position to release the button, then the reset is successful.

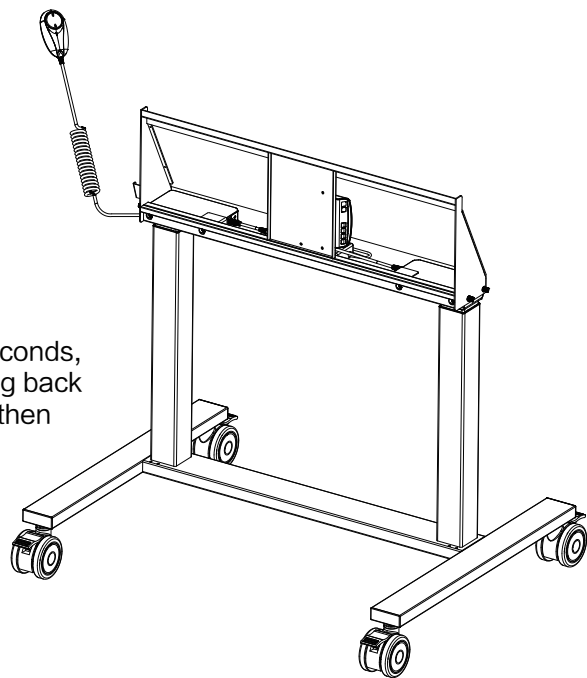

Assembly steps

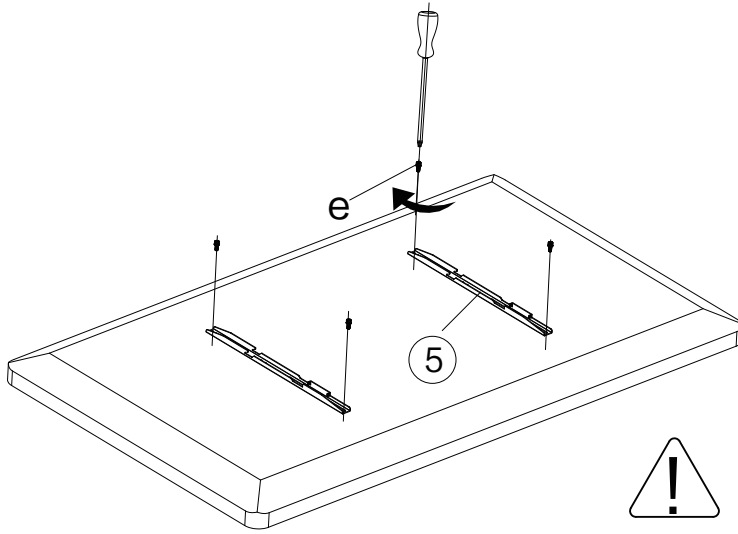

 Make sure the screws are locked.

*If the display is non-standard, you can choose different scenarios according to matching different monitors.

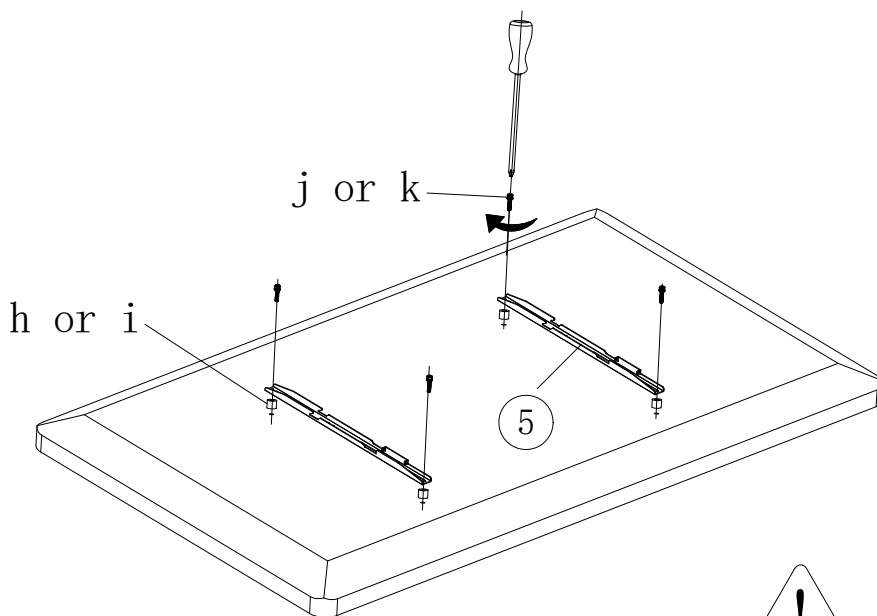

Scene1  h With  j

Scene2  i With  k

 Make sure the screws are locked.

Assembly steps

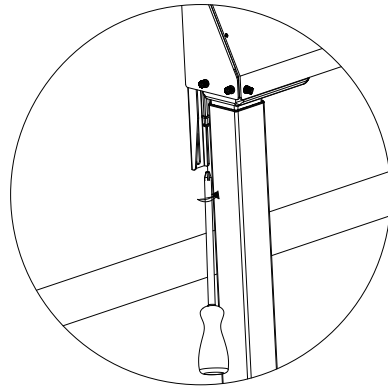
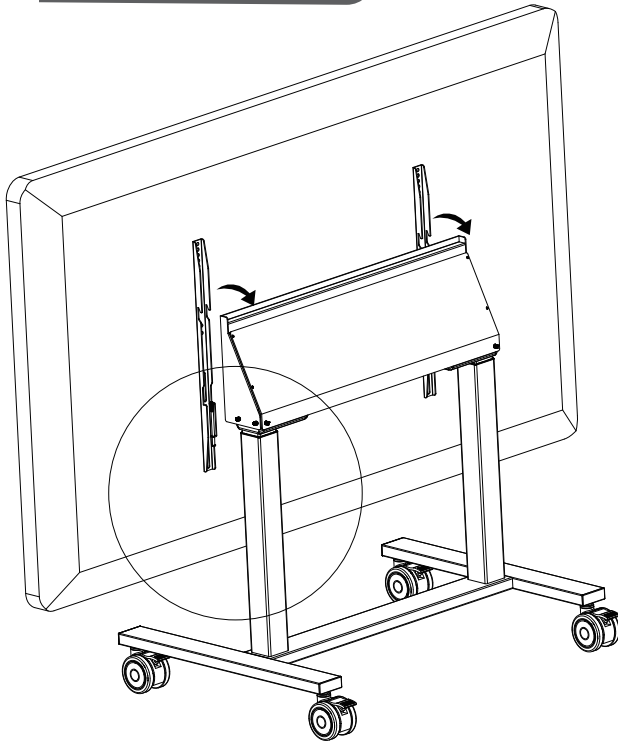

Make sure the screws are locked.

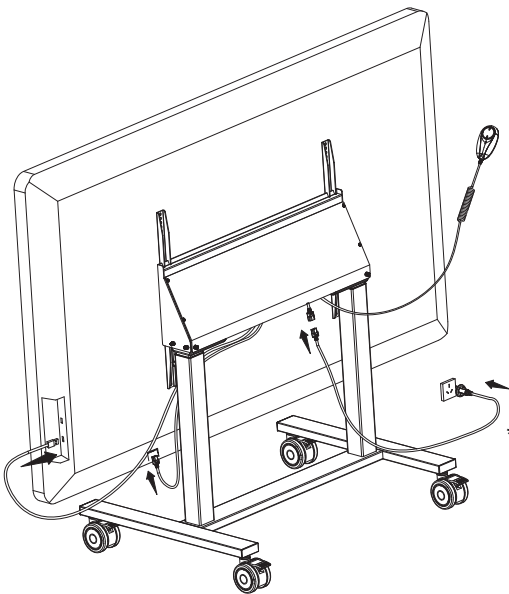

*This cable comes from the monitor.



The socket connections of the unit and the wall socket must be easily accessible. Disconnect mains plug before moving the product.

Assembly steps

*You can use wire buckles for wire arrangement.

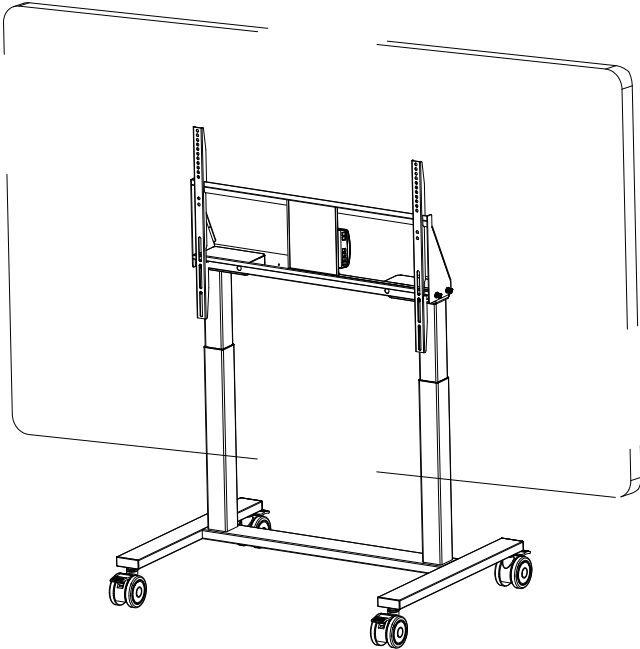
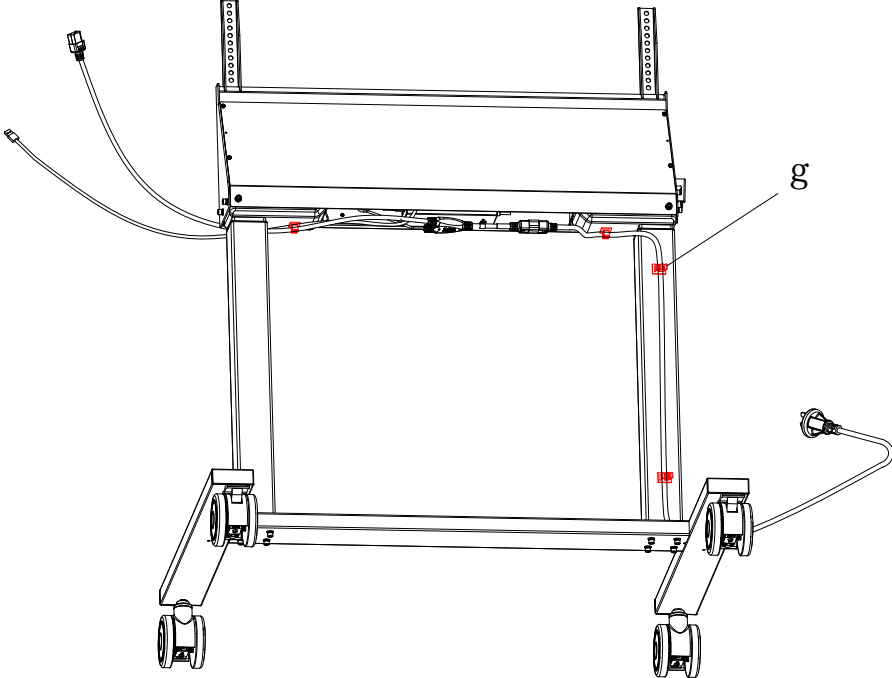

Done,enjoy!

Control Mode

Control Panel

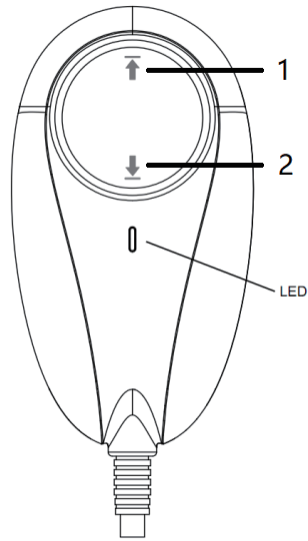

No.	Items	Function description
1	UP	Control the rise of the Electric Stand.
2	Down	Control the fall of the Electric Stand.
3	LED	As long as it's connected to power, the LED will light up.

NOTE:

It is necessary to be reset manually after initial installation or power off suddenly.

Reset scheme: Long press the down button for about 5 seconds, the Electric Stand slowly downward, spring back to the initial position to release the button, then the Electric Stand can be used normally.

Control Mode

The software of the Intelligent Panel

Step1: Ensure that the Intelligent Panel is connected with the Electric Stand by USB transferable Cable.

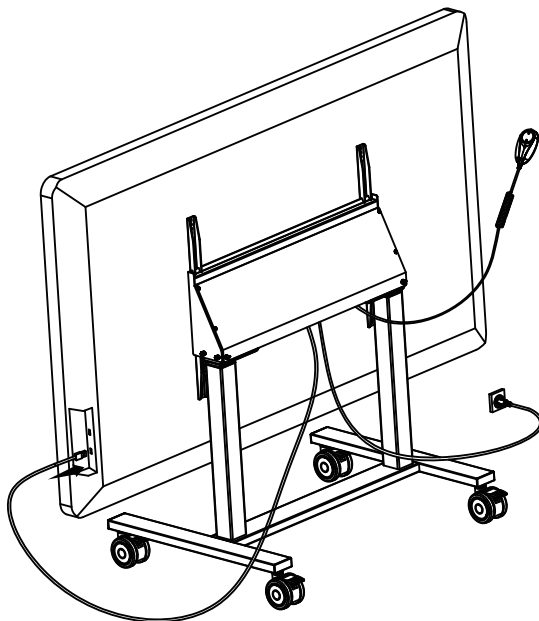

Control Mode

Step2: Turn on the Intelligent Panel, the sidebar of the Intelligent Panel will display the control button of the Electric Stand.

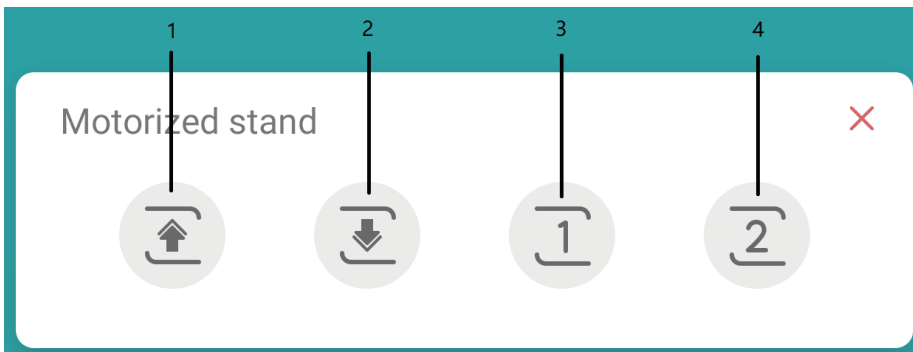
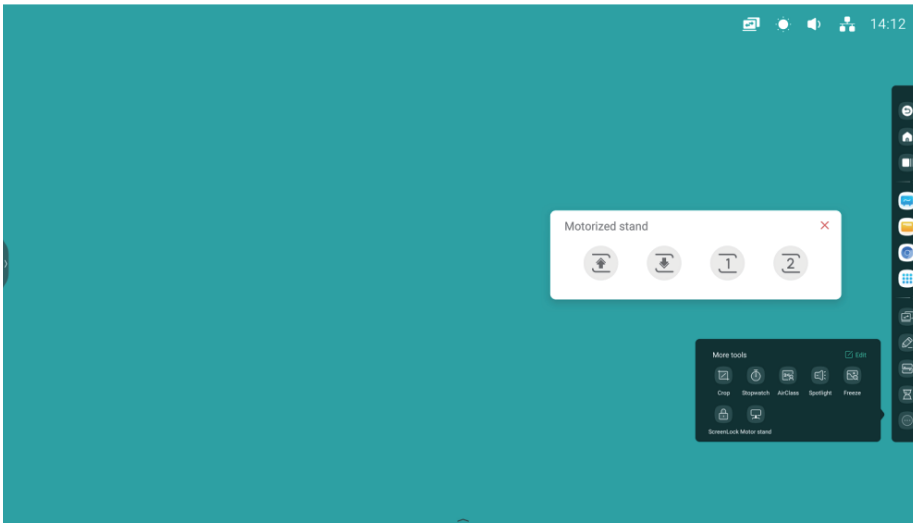

No.	Items	Function description
1	UP	Control the rise of the Electric Stand.
2	Down	Control the fall of the Electric Stand.
3	Lift memory key 1	Move to the first height,Long press this key till the display shows"Save the first height".Next time,when you click on the key again,display shows"Move to the first height",the Electric Stand will move to the first height.
4	Lift memory key 2	Move to the second height,Long press this key till the display shows"Save the second height".Next time,when you click on the key again,display shows"Move to the second height",the Electric Stand will move to the second height.

